

# HIVE-1000

## Dual Frequency 2-Relay Receiver with Bluetooth Programming



### Product Description

The HIVE-1000 receiver is designed with the latest technology, featuring a built-in Bluetooth module for seamless two-way communication with smartphones. Using the Hive-1000 mobile app, available for both iOS and Android, users can easily manage receiver settings and pair transmitters.

The HIVE-1000 also supports simultaneous operation at both 318 MHz and 433 MHz frequencies, ensuring flexible and reliable performance."

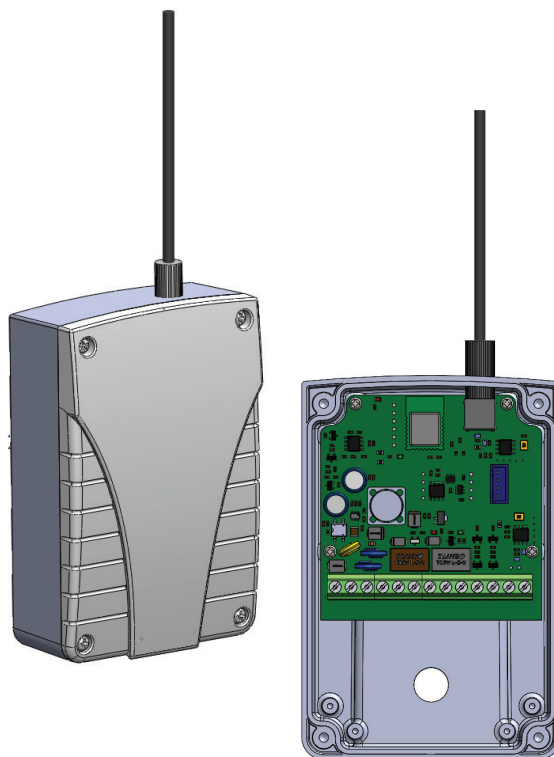

### Key Features

- Simplifies managing receiver settings and pairing transmitters via a Bluetooth App for both iOS and Android
- Operates at both 318 MHz and 433 MHz simultaneously
- Allows up to 1024 Transmitters split equally between frequencies; 512 @ 318 MHz and 512 @ 433 MHz
- Operates with most common 318 MHz protocols and Keeloq® Hopping code security protocol

 Certification

 DEEE

**RoHS** Certification

 IP55

 -22°F to 158°F

# HIVE-1000 Dual Frequency 2-Relay Receiver with Bluetooth Programming

## TECHNICAL SPECIFICATIONS

Receiver type:	Superheterodyne.
Demodulation:	AM/ASK.
Receiver bandwidth:	330 kHz
Operating frequency:	433.92 Mhz / 318 MH
Sensitivity ( for good signal ):	-116 dBm @ 433 MHz -111 dBm @ 318 MHz
Input load:	50 Ohm.
Power supply :	12 or 24 Vac/dc.
Current consumption ( @12Vdc)	160 mA (max)
N° of relays:	2 x (NO / NC).
Relay contact rating:	1 A @ 30 Vdc, 0.5 A @125 Vac
Max relay switching voltage:	125 Vac / 60Vdc
Min relay contact current:	1 mA @ 5V
Transmitter Memory capacity:	512 @ 318 MHz + 512 @ 433.92 MHz
Security protocols	Linear MegaCode® Keeloq® Hopping code
Max. number of facility codes:	4
Operating temperature:	-22 to 158 °F
Dimensions ( Fig. 2):	4.8 x 3.2 x 1.6 inches
Weight:	5.6 Ounces

The HIVE -1000 is bluetooth enabled and controlled via a smartphone app in either "SMART" or "CLASSIC" programming mode depending on user preference

## "SMART" Programming "CLASSIC" Programming

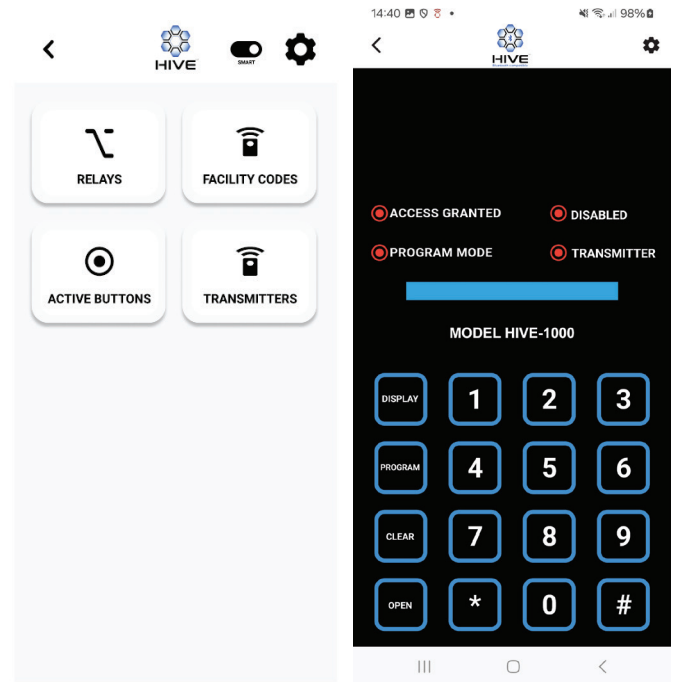

## Compatible Transmitter Solutions Transmitters



### Hive-1000 Receiver works with the following transmitters:

#### 318 MHz:

1-button, 2-button, and 4-button Luna® Models  
1-button and 2-button Monarch® Models  
1-button and 2-button Stingray® Models

#### 433 MHz:

1-button and 2-button Monarch® Models  
1-button, 2-button, and 4-button Stingray® Models

### Other compatible remotes:

#### 318 MHz:

Linear® MCT-1/MDT-1, Linear® MCT-2/MDT-2

Start configuring your receiver today

Download Hive-1000 App for iOS



Download Hive-1000 App for Android

